

Fitting Instructions

Revo Carbon Intake Kit 2.5 TFSI RS3 (8V.2)/TTRS (FV)

Fitting Difficulty



Contents

Description	Quantity
Revo Carbon Airbox Lid	1
Revo Carbon Intake Pipe	1
Revo Turbo Intake Hose	1
Revo Air Filter	1
Revo Airbox Hose	1
Breather Coupler	1
6mm Self Seal	1
6mm Washer	1
Flange Nut	1
90-110 Hose Clamp	2
23-35 Hose Clamp	1
80-100 Hose Clamp	1
9-12 Hose Clamp	1
6mm ID Vacuum Hose - 370mm	1
5mm ID Rubber Washer	8

Recommended Tools

Tools	Size
Ratchet	
Ratchet Extension	
Sockets	7mm
Torx Bits	T25
Constant Tension Pliers	
Side Cutters	



Before starting, please ensure that the battery is disconnected and you have ensured the engine is cool. Engine temperatures can remain high for a substantial amount of time after use.

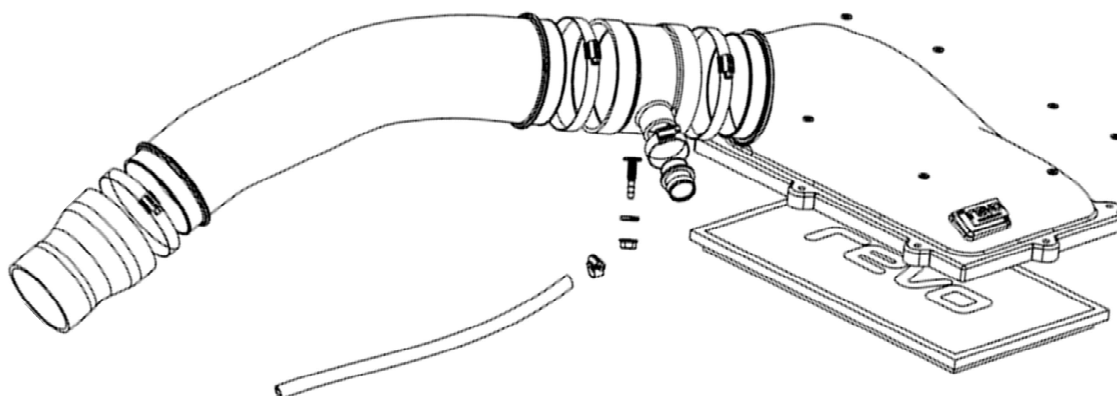

Fitting Instructions

Revo Carbon Intake Kit 2.5 TFSI RS3 (8V.2)/TTRS (FV)

Fitting Difficulty



 Installation was performed on a UK spec. TTRS (FV). Installation on other vehicles will be similar but may not be exact.

1 Remove the engine cover by pulling upwards.



2 Loosen the 2 x hose clamps holding the rubber hose in place and remove from the vehicle.



3 Loosen the hose clamp holding the intake pipe onto the turbo inlet.



4 Remove the T30 bolt holding the intake pipe to the engine block.

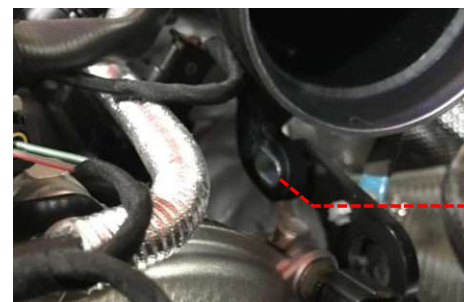

Fitting Instructions

Revo Carbon Intake Kit 2.5 TFSI RS3 (8V.2)/TTRS (FV)

Fitting Difficulty



- 5 Using side cutters, remove the clamp that secures the vacuum line to the top of the engine. Now remove the pipe from the vehicle.

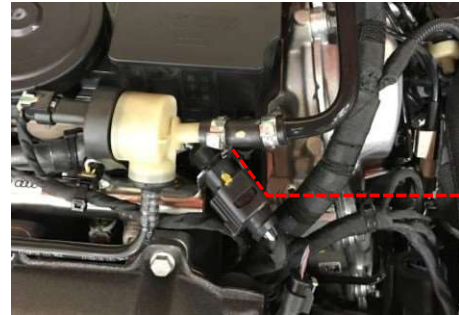

- 6 Loosen the hose clamp holding the breather hose onto the airbox lid and remove the hose.



- 7 Using a T25, remove the 8 x bolts that secure the airbox lid and remove the lid from the vehicle.

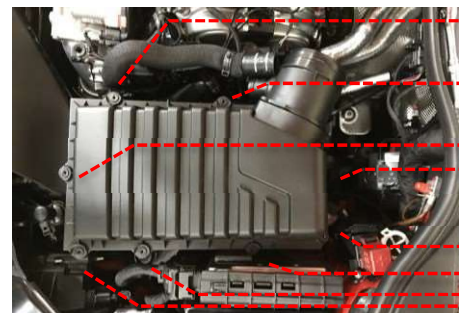

- 8 Replace the OE air filter with the new Revo air filter (supplied). Next, fit the Revo carbon airbox lid and secure using the 8 x T25 bolts, each with a rubber washer under the head of the bolt. Tighten to 3Nm.

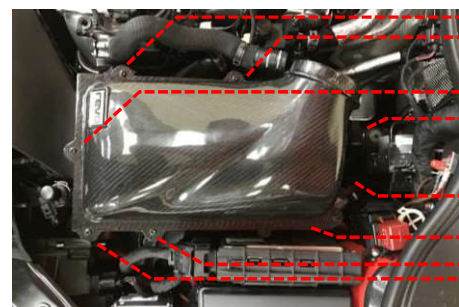

Fitting Instructions

Revo Carbon Intake Kit 2.5 TFSI RS3 (8V.2)/TTRS (FV)

Fitting Difficulty



- 9 Fit the Revo turbo intake hose to the turbo inlet but do not tighten the hose clamps yet.



- 10 Attach the vacuum line (supplied) to the fitting on the Revo airbox coupler hose and secure with the hose clamp (supplied).



- 11 Fit the Revo airbox hose to the Revo airbox outlet, do not tighten the hose clamp yet. Next, fit the breather hose onto the take-off and secure using the OE hose clamp.



- 12 Attach the supplied vacuum line by pushing over the take-off. This does not need to be clamped.



Fitting Instructions

Fitting Difficulty



Revo Carbon Intake Kit 2.5 TFSI RS3 (8V.2)/TTRS (FV)

- 13 Fit the Revo carbon intake pipe and position so that the hoses at either end fit tightly against both the airbox and turbo inlet. Once you are satisfied with the positioning, tighten all 4 x hose clamps to 3Nm.

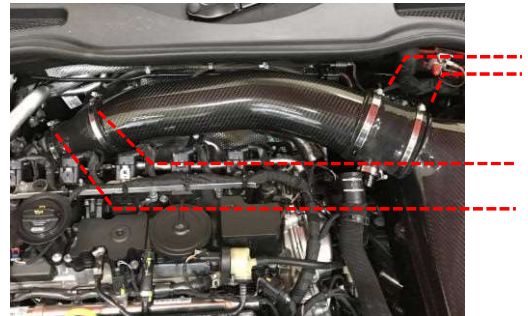

- 14 Refit the engine cover. Test drive the vehicle to ensure there are no leaks/part interference during operation. Your installation is now complete!



Fitting Instructions

Revo Carbon Intake Kit 2.5 TFSI RS3 (8V.2)/TTRS (FV)

Fitting Difficulty

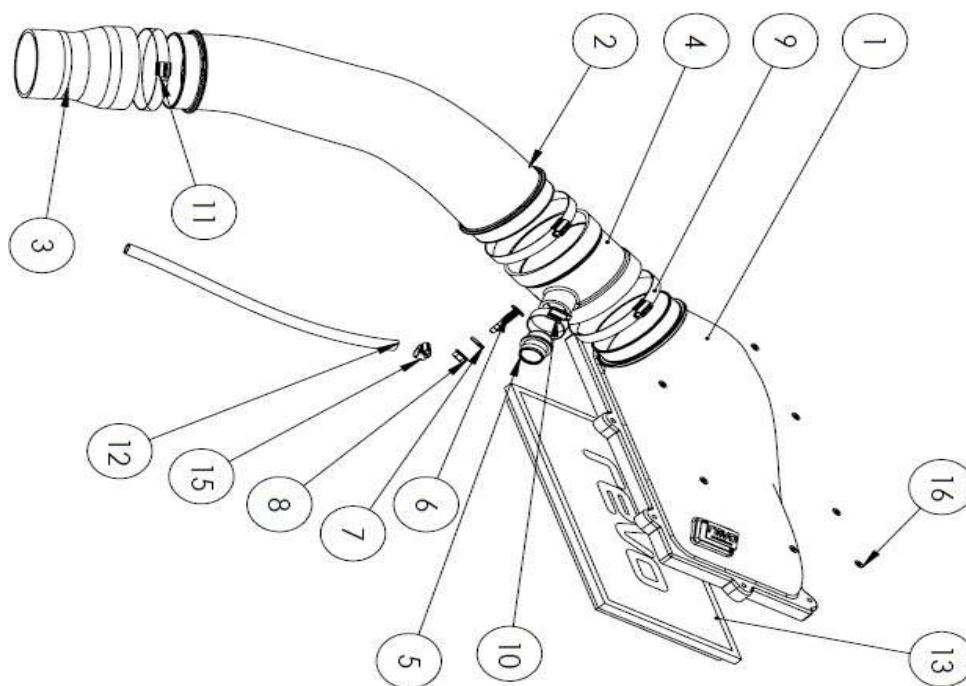

No.	DESCRIPTION	QTY.
1	TTRS/RS3 CARBON AIRBOX LID	1
2	TTRS/RS3 CARBON INTAKE PIPE	1
3	TURBO INLET SILICONE	1
4	AIRBOX SILICONE COUPLER	1
5	6MM SELF SEAL	1
6	6MM WASHER	1
7	6MM FLANGE NUT	1
8	HOSE CLAMP 90-110	2
9	HOSE CLAMP 23-35	1
10	HOSE CLAMP 90-110	1
11	HOSE CLAMP 80-100	1
12	6MM ID VACUUM HOSE - 370MM	1
13	TTRS/RS3 PANEL FILTER	1
14	HOSE CLAMP 9-12	1
15	5MM ID 10MM OD RUBBER WASHER	8